

CEILING KEY	
KEY	DESCRIPTION
BH	BULKHEAD WHERE CHANGE IN CEILING HEIGHT
BK	UNDERSIDE OF BONDEK SLAB
CB	UNDERSIDE OF CONCRETE BAND BEAM
CFC	COMPRESSED FIBRE CEMENT SHEETING SUCH AS HARDIEFLEX
FPB	FLUSHED AND PAINTED PLASTERBOARD
FTR	FASCIA TRUSS
RC	RECESSED CEILING CURTAIN TRACK
TB	TIMBER-LOOK BATTENED CEILING - INNOCEL SHIPLAP CEILING CLADDING IN WESTERN RED CEDAR, INSTALLED TO MANUF. DTLS
WPB	WATERPROOF FLUSHED PLASTERBOARD CEILING WITH MOULD RESISTANT PAINT

ENSURE ALL LOAD BEARING STEEL NOT WITHIN A FIRE RATED WALL (WT8 & WT9) HAS PROMAT CAFCO 300 VERMICULITE APPLIED PRIOR TO 1ST FIX SERVICES AND LINING WALLS AND CEILINGS

CROSSHATCHED AREA - R3.7 MIN REQUIRED TO ROOF OF POOL AREA (SYSTEM TOTAL) R1.3 ANTI-CON BLANKET TO UNDERSIDE OF ROOF WITH R3.7 CEILING INSULATION BATTAS AN EXAMPLE FOR ACHIEVING THIS RATING

COFFERED CEILING DROPPED TO 2200AFL AROUND POOL DECK AREA TO ALLOW SPACE FOR DUCTWORK & DRAINAGE AS PER MECHANICAL LAYOUTS. DUCTWORK SIZING TBA

DOTTED AREA - INSULATION BETWEEN POOL DECK AND APARTMENT ABOVE - 4.0mm R2.0 RIGID SOFFIT BOARD OR INSULATION BATTAS TO CEILING

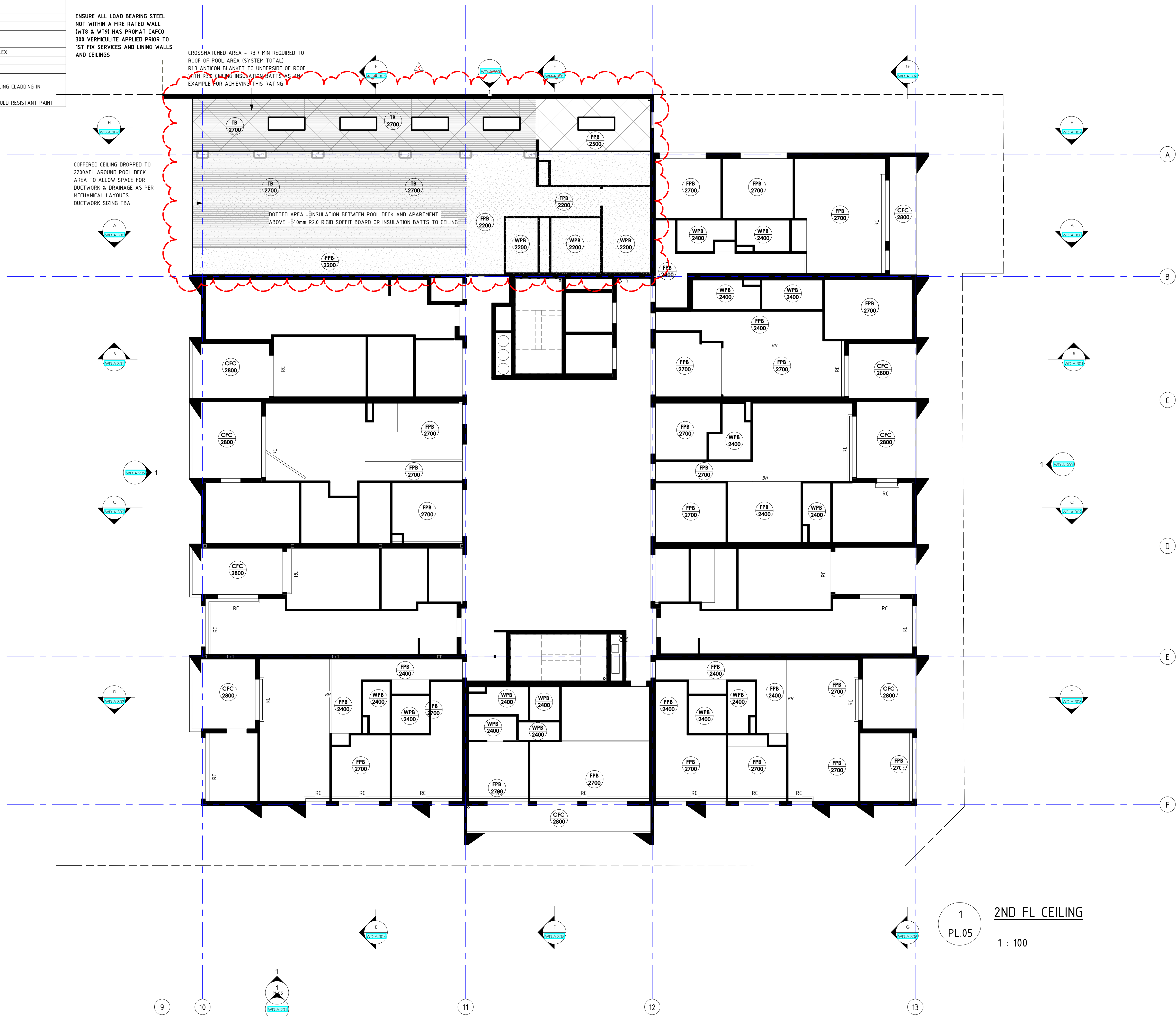

1
PL.05

2ND FL CEILING

1 : 100

This drawing shows design information and is not to be used for construction purposes. It is the responsibility of the client to ensure that the design is suitable for the intended use and that all necessary approvals are obtained before construction commences.

REVISIONS

ISSUE #	DATE	DESCRIPTION
A	25/03/2019	FOR BRC APPROVAL
B	14/05/2019	REVISED SET BASED ON BRC RFI PCS9515
K	17/01/2020	REMOVE 4 COLUMNS IN BSMT, CHANGE TO APT 209,411,105, OPEN POOL AREA + AS CLOUDED

PROJECT ADDRESS

248 UNLEY ROAD HYDE PARK

HYDE PARK PLACE - STAGE A

CLIENT

HYDE PARK PLACE PTY LTD

CITIFY



SHEET

RCP 2ND FLOOR

WD.A.503

AUTHOR

GB

REV #

K

REVISION DESCRIPTION

REMOVE 4 COLUMNS IN BSMT, CHANGE TO APT 209,411,105, OPEN POOL AREA + AS CLOUDED

ISSUE DATE

17/01/2020

FOR CONSTRUCTION

GEMMA

www.gemmalia.com.au
gemma@gemmalia.com.au
ABN: 55 882 991 838

LEA

DESIGN STUDIO